

SONOFF

DIY ZBDongle

User manual V1.1



Zigbee 3.0 USB Dongle Plus

CN · EN · DE · ES · FR · IT · RU · PT

产品简介

Product Introduction

Produkt Einführung

Introducción del producto

Présentation du produit

Introduzione al prodotto

Описание продукции

Introdução do produto

SONOFF Zigbee 3.0 USB Dongle Plus 基于 TI CC2652P+CP2102N, 预刷了 Z-Stack 3.x.0 协调器固件, 可以直接连接到您的计算机或树莓派, 通过 ZHA 或 Zigbee2MQTT 的方式连接到 Home Assistant 或其他开源平台中, 作为 ZigBee 网关。还可插入路由器固件作为路由设备扩展网络范围。

SONOFF Zigbee 3.0 USB Dongle Plus is designed to hook directly into your computer or Raspberry Pi and can be used as a coordinator or router for your Zigbee network through ZHA or Zigbee2MQTT in open-source automation platforms like Home Assistant. It is based on the TI CC2652P+CP2102N and pre-flashed with the Z-Stack 3.x.0 coordinator firmware.

Der SONOFF Zigbee 3.0 USB Dongle Plus ist so konzipiert, dass er direkt an Ihren Computer oder Raspberry Pi angeschlossen werden kann und als Koordinator oder Router für Ihr Zigbee-Netzwerk über ZHA im Home Assistant verwendet werden kann. Er baut auf dem TI CC2652P+CP2102N auf und mit der offiziellen Z-Stack 3.x.0 Koordinator-Firmware vorgeflashed ist.

O SONOFF Zigbee 3.0 USB Dongle Plus está desenhado para conectar-se diretamente a su computadora o Raspberry Pi y puede utilizarse como coordinador o router para su red ZigBee a través de ZHA en Home Assistant. Está basado en el TI CC2652P+CP2102N y está pre-expuesto con el firmware oficial del coordinador Z-Stack 3.x.0.

1

Le SONOFF ZigBee 3.0 USB Dongle Plus est conçu pour se brancher directement sur votre ordinateur ou Raspberry Pi et peut être utilisé comme coordinateur ou routeur pour votre réseau ZigBee via ZHA dans Home Assistant. Il est basé sur le TI CC2652P+CP2102N et pré-flashé avec le firmware officiel du coordinateur Z-Stack 3.x.0.

Il dongle Plus SONOFF ZigBee 3.0 USB é projetado para se conectar diretamente ao seu computador ou Raspberry Pi e pode ser usado como um coordenador ou roteador para sua rede ZigBee através do ZHA no Home Assistant. Ele é baseado no TI CC2652P+CP2102N e pré-flashado com o firmware oficial do coordenador Z-Stack 3.x.0.

Модуль SONOFF ZigBee 3.0 USB Dongle Plus предназначен для подключения непосредственно к Вашему компьютеру или Raspberry Pi и может быть использован в качестве координатора или роутера для Вашей сети ZigBee через ZHA в Home Assistant. Он основан на TI CC2652P+CP2102N и предварительно прошил официальной прошивкой координатора Z-Stack 3.x.0.

O SONOFF Zigbee 3.0 USB Dongle Plus foi projetado para se conectar diretamente ao seu computador ou Raspberry Pi e pode ser usado como um coordenador ou roteador para sua rede ZigBee através do ZHA no Home Assistant. Ele é baseado no TI CC2652P+CP2102N e pré-flashado com o firmware oficial do coordenador Z-Stack 3.x.0.

2

安装天线

Antenna Installation

Antenneninstallation

Instalación de la antena

Installation de l'antenne

Instalazione dell'antenna

Установка антенны

Instalação da antena

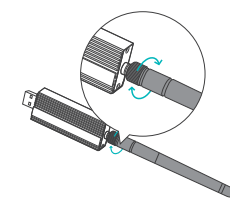

3

LIKE IT!

Glad to know you are satisfied with SONOFF products. It would mean a lot to us if you can take a minute to share your buying experience.



Share it on Amazon



Share it on your social media



Share it with your friends and family

Get the latest news by following us:

New arrival Promotion How-to videos

HAVE A PROBLEM?

We are so sorry for the inconvenience caused by the product. Please contact us for help via the email address below.



support@itead.cc

We will get back to you as soon as possible.



支持广泛的设备类型

Supported Device Types

Unterstützte Gerätetypen

Tipos de dispositivos compatibles

Types de dispositifs pris en charge

Tipi di dispositivi supportati

Поддерживаемые типы устройств

Tipos de dispositivos suportados

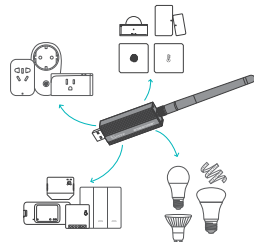

4

更多教程

More Detailed Tutorials

Ausführlichere Anleitungen

Tutoriales más detallados

Tutoriels plus détaillés

Tutorial più dettagliati

Более подробные инструкции

Tutoriais mais detalhados



<https://sonoff.tech/uncategorized/zigbee-3-0-usb-dongle-plus/>

扫码或输入网址观看设备使用详细教程。

Scan the QR code or enter the URL to view the detailed tutorial.

Scannen Sie den QR-Code oder geben Sie die URL um die ausführliche Anleitung zu sehen.

Escanee el Código QR o ingrese a URL para ver el tutorial detallado.

Scannez le code QR ou saisissez l'URL pour consulter le tutorial détaillé.

Scansiona il codice QR inserisci l'URL per visualizzare il tutorial dettagliato.

Отсканируйте QR-код или введите URL-адрес для просмотра подробных инструкций.

Digitalize o código QR ou digite o URL para ver o tutorial detalhado.

5

FCC Warning

Changes or modifications not expressly approved by the party responsible for compliance could avoid the user's authority to operate the equipment.

This device complies with part 15 of the FCC Rules. Operation is subject to the following two conditions:

(1) This device may not cause harmful interference, and (2) this device must accept any interference received, including interference that may cause undesired operation.

FCC Radiation Exposure Statement:

This equipment complies with FCC radiation exposure limits set forth for an uncontrolled environment. This equipment should be installed and operated with minimum distance 20cm between the radiator & your body. This transmitter must not be co-located or operating in conjunction with any other antenna or transmitter.

Note:

This equipment has been tested and found to comply with the limits for a Class B digital device, pursuant to part 15 of the FCC Rules. These limits are designed to provide reasonable protection against harmful interference in a residential installation. This equipment generates, uses and can radiate radio frequency energy and, if not installed and used in accordance with the instructions, may cause harmful interference to radio communications. However, there is no guarantee that interference will not occur in a particular installation. If this equipment does cause harmful interference to radio or television reception, which can be determined by turning the equipment off and on, the user is encouraged to try to correct the interference by one or more of the following measures:

- Reorient or relocate the receiving antenna.
- Increase the separation between the equipment and receiver.
- Connect the equipment into an outlet on a circuit different from that to which the receiver is connected.
- Consult the dealer or an experienced radio/TV technician for help.

6

Hereby, Shenzhen Sonoff Technologies Co., Ltd. declares that the radio equipment type ZBDongle-P is in compliance with Directive 2014/53/EU. The full text of the EU declaration of conformity is available at the following internet address:

<https://sonoff.tech/usermanuals>

SONOFF

Shenzhen Sonoff Technologies Co., Ltd.

1001, BLDG8, Lianhua Industrial Park, Shenzhen, GD, China

ZIP code: 518000

Website: sonoff.tech

MADE IN CHINA



7

品牌	松诺/SONOFF
物料	ZBDongle-P 说明书 V1.1
材料	105g铜板 四色印刷 手风琴5折页
尺寸	展开: 190x80mm 折后: 38x80mm
日期	2021.10.08