

REVISIONS			
REV	DESCRIPTION	DATE	BY

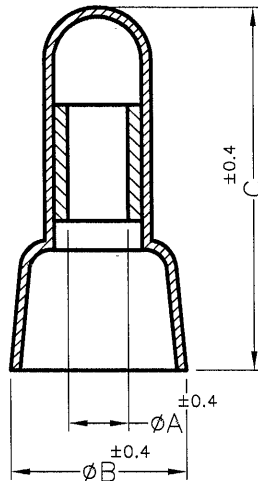
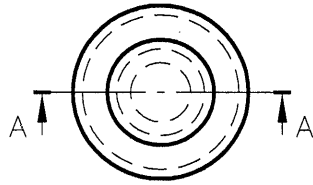

SECTION A-A

PART NO.	WIRE RANGE	A	B	C
CE1	#22-#18AWG	2.6	7.8	18.0
CE2	#22-#14AWG	3.1	9.5	20.0
CE5	#22-#10AWG	4.4	12.5	25.2

符合歐盟ROHS規範 (RoHS Compliant)	
★鉛Pb	<1000PPM
★鎘Cd	< 100PPM
★汞Hg	<1000PPM
★六價鉻Cr6+	<1000PPM
★多溴聯苯類PBBs	<1000PPM
★多溴聯苯醚類PBDEs	<1000PPM
★有鹵料件 Halogen-containing Product	

VOLTAGE: 300V(MAX)

TEMPERATURE: 105°C(MAX)

NOTE: ALL MEASUREMENT DOES NOT INCLUDE GATE WHICH RAISES UNDER 0.3mm.

所有尺寸量測皆不含進膠口, 膠口凸出0.3mm



<p>康揚企業股份有限公司 KANG YANG HARDWARE ENTERPRISE CO., LTD. 康揚塑膠(東莞)有限公司 KANG YANG PLASTIC(DONG GUAN) CO., LTD. 康哲電腦配件(吳江)有限公司 KANG CHE COMPUTER COMPONENTS(WUJIANG) CO., LTD.</p>				TITLE	CLOSE END WIRE CONNECTOR	SPEC. DWG.
				HOUSING MATERIAL	NYLON 66 UL94V-2	DATE
PART NUMBER		DRAWING NUMBER	MATEL MATERIAL		DRAWN	
SEE ABOVE		CE-H	ALUMINUM		JASON	
SIZE	SCALE	UNIT	HOUSING COLOR	CHECK		
A4	NONE	mm	NATURAL	Will		
UNLESS OTHERWISE SPECIFIED TOLERANCE			SEE ABOVE	APPROVED		
				Kang		