

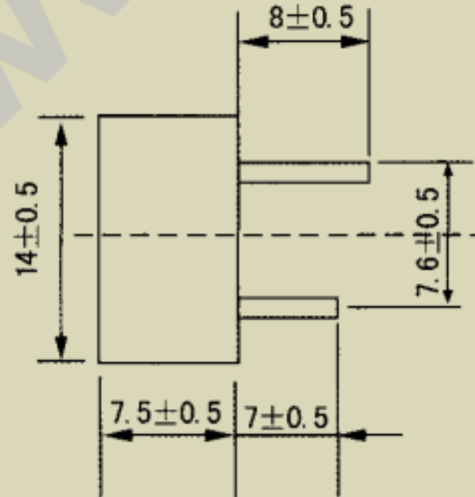

SFM-14-I

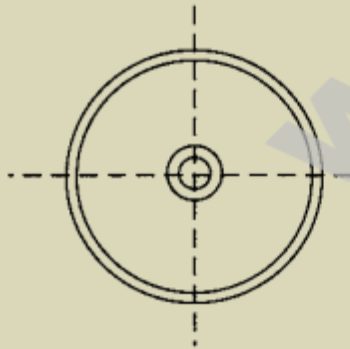

Type	SFM-14-I
Rated Voltage(V)	12
Voltage Range(V)	3-24
Rated Current(mA)	≤10
Sound Output(dB)	≥80
Resonant Freq(Hz)	4500 ± 500
Operating Temp(°C)	-20~+60
Storage Temp(°C)	-30~+70
Weight(g)	2